



**LCU-2S**  
**Liquid Supply System**  
**User Manual**  
**- English**  
**- 中文**



1.	Introduction .....	1
2.	Safety Information.....	1
3.	Package Contents & Inspection.....	2
4.	Machine Details.....	3
5.	Technical Label Information .....	3
6.	Setting and Manual Operation.....	3
7.	Service and Maintenance.....	4
8.	Technical Specifications.....	5
9.	Warranty Disclaimer.....	5
10.	Machine Dimension.....	6
1.	前言 .....	7
2.	安全注意事項 .....	7
3.	包裝內容與檢查 .....	8
4.	機器訊息 .....	9
5.	技術標籤資訊 .....	9
6.	設定與手動操作說明 .....	9
7.	維護和保養 .....	11
8.	技術規格 .....	11
9.	保固聲明 .....	12
10.	機器尺寸圖 (換圖) .....	12

# LCU-2S



LIQUID SUPPLY UNIT

## User Manual

### 1. Introduction

Please read all the user manual before operating the machine, and place the manual where the user can refer to it at all time. The manual includes how to install and operate the machine under safe conditions and explain all the labels printed on the machine. If you encounter any problem, contact your local Antari dealer for assistant immediately.

### 2. Safety Information

 <b>DANGER</b>	If the danger is not avoided, it will cause death or serious injury
 <b>WARNING</b>	If the warning is not heeded, it can cause death or serious injury.
 <b>CAUTION</b>	If the precaution is not taken, it may cause minor or moderate injury.



#### **DANGER**

- Must connect the machine to the correct rated voltage or it might lead to an electrical shock or a burn and may cause serious consequences.
- Do not operate the machine with a bundled power cord, it could lead to a fire hazard.
- When operating the machine, do not point at people, animals, or fire.



#### **WARNING**

- Please operate the machine on a flat, level hard and well ventilated surface area, reserve at least 50cm space around the machine and make sure there is no flammable gas or material nearby.
- Do not disassemble, repair or modify the machine, it may cause damages, malfunction, risk of electrical shock or result in fire.
- The machine can only be operated by adults or professionals, is not intended for use by person with reduced physical sensory, mental capabilities, or lack of experience and knowledge including children.
- Do not leave the machine running unattended, make sure all powers are off when leaving.
- Children should be supervised to ensure that they do not play with the machine.
- Do not use the machine upside down or tilt it, it might cause damages or malfunction.
- Please store the fluid inside in a well ventilated area without direct sunlight and keep out of reach of children. In case of eye contact or accidentally swallow the fluid, please seek medical attention immediately.



#### **CAUTION**

- Keep the machine dry at all time. The machine is not waterproof, do not expose the machine to water, rain or moisture environment.
- Please make sure the power outlet is not damaged or loose before plug in the power cord.
- If the power cord is damaged, it must be replaced by Antari or its local dealers, otherwise the warranty will be void.
- Before transporting the machine, please make sure the fluid is drained and tank is empty. (Recommend using original package)
- The machine is for indoor use only.
- Do not operate the machine in any area with unstable voltage.
- If you experience strange sound or malfunction, turn off the power and unplug the power cord immediately

and contact your local Antari dealer for assistant.

- Do not contact any moving part.
- Only use accessories recommended or sold by Antari.
- Please make sure the power is off when not using the machine and unplug the power cord if not intend to use for a long period of time.
- To disconnect, turn all controls to the off position, then remove plug from outlet.
- Do not unplug by pulling on cord. To unplug, grasp the plug, not the cord.
- Unplug from outlet before servicing or cleaning.
- Do not operate the machine with a damaged cord or plug, or after the machine malfunctions or is dropped or damaged in any manner. Return machine to the nearest authorized service facility for examination, repair, or electrical or mechanical adjustment.
- To ensure the lifespan of the machine, please only use the fluid manufactured by Antari, do not use other fluid or additive, otherwise it may cause malfunction.

Before operating the machine, please read all warning labels on the machine, description as below;

#### Bottom Cover Printing

##### Front

NEVER ADD FLAMMABLE SUBSTANCE  
USE ANTARI RECOMMENDED FLUID

##### Back

#### **CAUTION**

TO REDUCE THE RISK OF FIRE, REPLACE ONLY WITH SAME SIZE AND TYPE OF FUES

### **3. Package Contents & Inspection**

Immediately upon receiving the machine, carefully unpack the carton, check the content to ensure it is the correct model and all parts are included. If any part appears to be damaged or missing during transportation, please contact your local dealer and return in original package for inspection.

#### **3.1 Package Contents**

- 1 x LCU-2S Main Unit
- 1 x LCU-2S Liquid Dispenser Unit
- 1 x IEC Power Cable
- 1 x 3-Pin Data Cable
- 1 x 12 Meter 6mm x 4mm Tube
- 1 x 10 Meter 4mm x 2.5mm Tube
- 3 x 4 to 4mm Adaptor
- 3 x 6 to 4mm Adaptor
- 1 x Fluid Filter
- 1 x Quick Start Guide

#### **3.2 Optional Accessories**

<b>Item Code</b>	<b>Description</b>
N/A	N/A

## 4. Machine Details

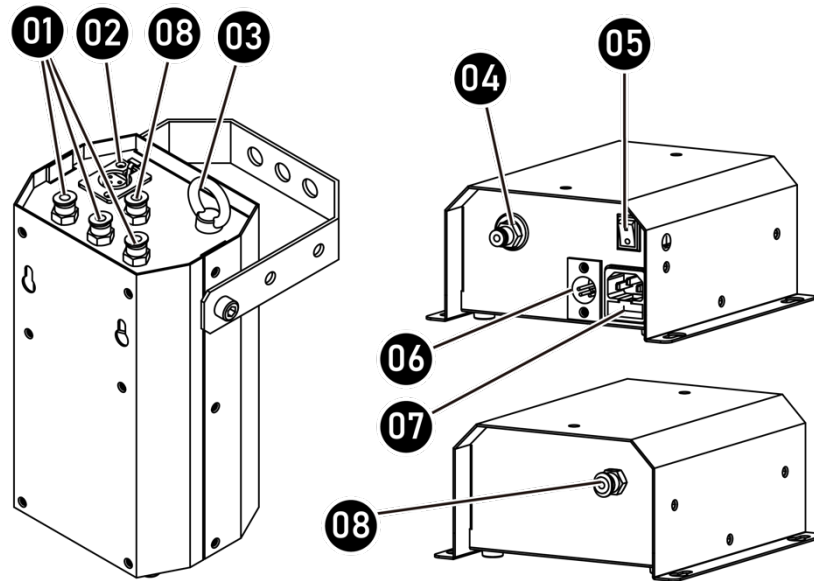

01. Fluid Output 4mm	05. Power Switch
02. XLR 3-Pin Connector (Data)	06. XLR 3-Pin Connector (Data)
03. Safety Ring	07. IEC Connector (Power)
04. Fluid Output 6mm	08. Fluid Input 6mm

## 5. Technical Label Information

Please read the technical label information on the back of the machine before operating it.

<p>The technical label contains the following information: 1. Model Name (XXXX), 2. Input Voltage (XXXX Vac), 3. Frequency (50/60Hz), 4. Rated Power (XXXW), 5. Breaker/Fuse (XXA 250V), 6. QR CODE for User Manual, and 7. Serial No. (XXXXXMMYYXXXXX). It also includes the text 'MADE IN TAIWAN' and a barcode.</p>	
1. Model Name	5. Breaker/Fuse
2. Input Voltage	6. QR CODE for User Manual
3. Frequency	7. Serial No.
4. Rated Power	

## 6. Setting and Manual Operation

	<b>WARNING</b>	Machine falling off might cause serious injury, please make sure it is secure and firm on the overhead.
--	----------------	---

### Fluid Connection (Graph 1)

- Use 6mm x 4mm tube to connect between “Dispenser Unit and Power Unit”, and “Power Unit and External Fluid Tank” (Must install filter on the tube that enter the fluid tank)
- Use 4mm x 2.5mm tube between “Dispenser Unit and Machine Fluid Tank Connector”

### Data Connection (Graph 2)

- A 3-Pin Cable is used for data connection between “Dispenser Unit and Power Unit”

**Note:**

Unit is equipped with overheat protection, when the unit exceed its temperature limit, it will automatically shut down until it reaches safe operating temperature.

**Graph 1**

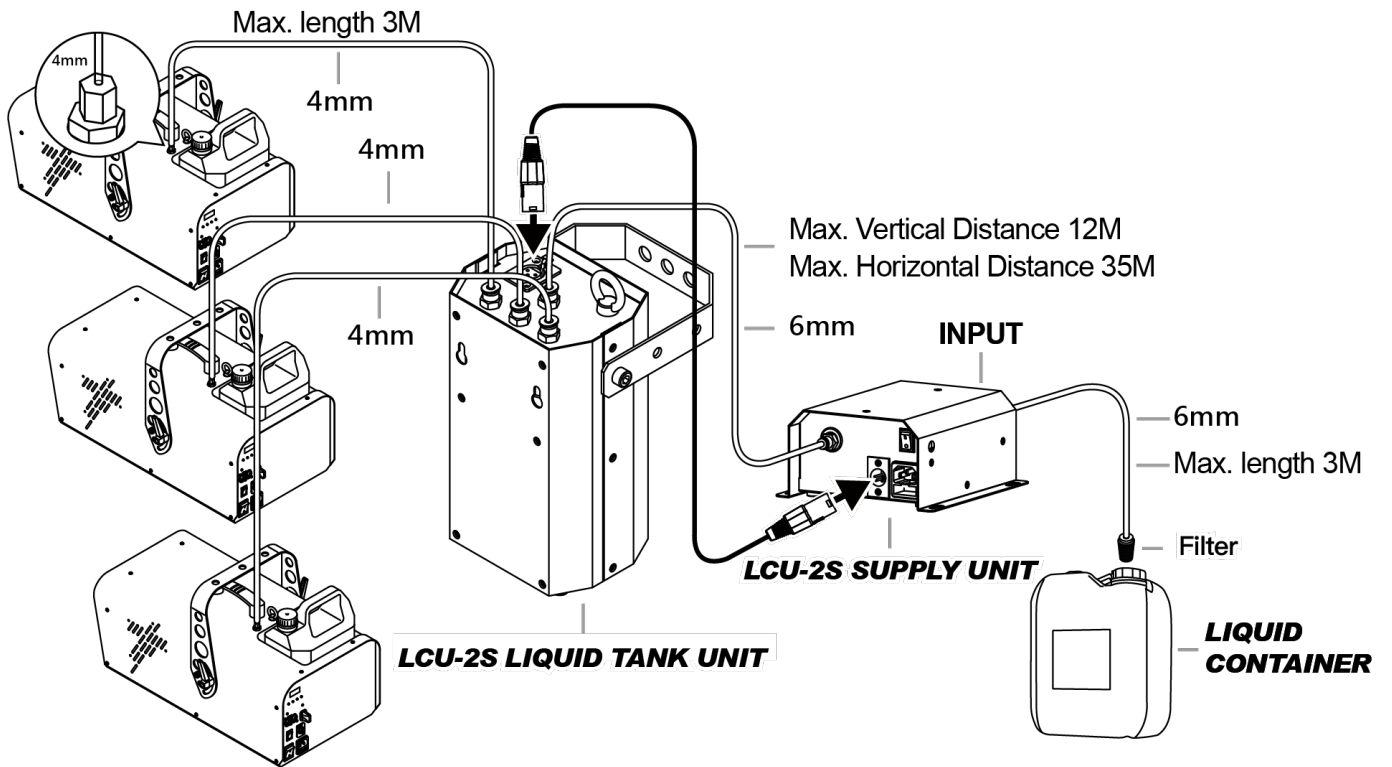

**Graph 2**

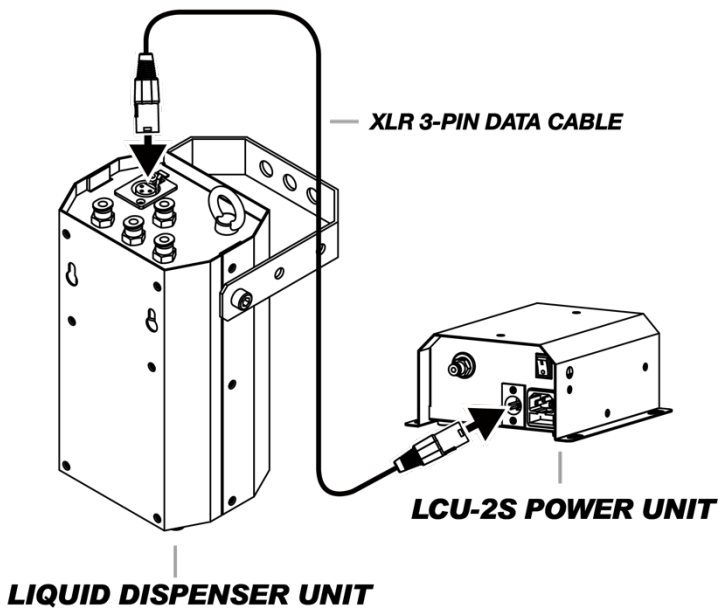

**7. Service and Maintenance**

	<b>DANGER</b>	Disconnect the power cord before starting maintenance operation
--	---------------	---

- Always keep the machine clean and dry.
- Can use an air compressor, a vacuum or a soft brush to remove the dust on the machine.
- Can use a slightly damp cloth to clean the casing.
- It is recommended to run the machine at least once a month in order to maintain its best performance and output condition.
- Excessive dust and build up liquid residue will reduce the performance and cause overheat.

**Fuse Specification**

120V = T0.8A 250V

230V = T0.8A 250V

**8. Technical Specifications**

	Main Unit	Dispenser Unit
Input Voltage	US Model : AC 100 - 120V, 50 / 60 Hz 0.5A EU Model : AC 220 - 240V, 50 / 60 Hz 0.5A	
Rated Power	55W	
Fluid Tank Capacity	0.8 Liters (0.21 Gallon)	
Compatible Fluid	Antari Fluid	
Ambient Temp. Range	5°C - 40°C (41°F - 104°F)	
Control Methods	Auto	
Interface	IEC (Power) XLR 3-Pin (Data Cable)	
Included Accessories	XLR 3-Pin Data Cable FT-6 12 Meter 6mm x 4mm Tube FT-4 10 Meter 4mm x 2.5mm Tube FTA-44 Adapter (4mm to 4mm) Adaptor *3 FTA-64 Adapter (6mm to 4mm) Adaptor *3 FLF-6 Fluid Filter	
Optional Accessories	N/A	
Dimension	<b>Supply Unit</b> L179 W168 H84 mm L7.05 W6.62 H3.31 inch <b>Tank Unit</b> L158 W103 H312 mm L6.22 W4.06 H12.29 inch	
Weight	<b>Supply Unit</b> 2.0 kg 4.40 lbs <b>Tank Unit</b> 1.8 kg 3.97 lbs	

**9. Warranty Disclaimer**

We guarantee the merchandise manufactured by us to be free from defect in material and workmanship for a period of one year. Our obligation and liability under this warranty shall be restricted to repair or replacement at our factory or local authorized dealer. We assume no liability of the products that are improperly used or used for any purpose other than that for which they are specially designed. This warranty shall not apply to any merchandise which has been repaired, altered or assembled outside our factory in any way so as in our judgment to affect its performance, nor which has been subjected to misuse, negligence, or accident nor to any merchandise operated contrary to our printed instructions. We will not allow or be liable of any loss or any damages of any kind in connection with the use, sale, or repair of any merchandise purchased from us.

## 10. Machine Dimension

### Main Unit

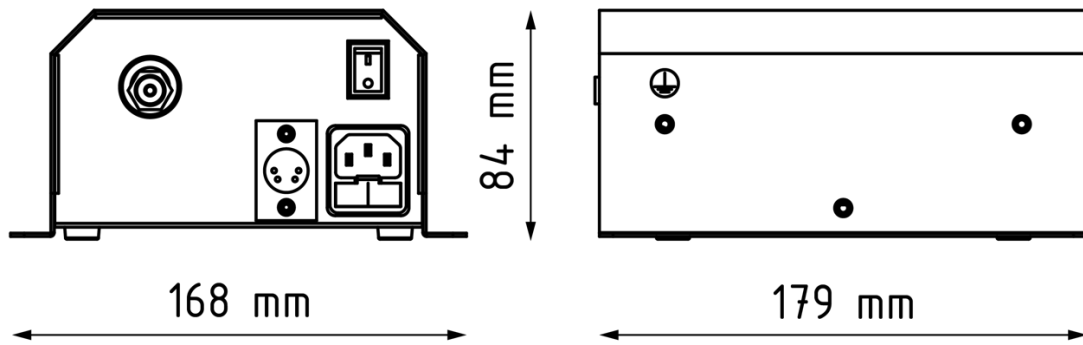

### Dispenser Unit

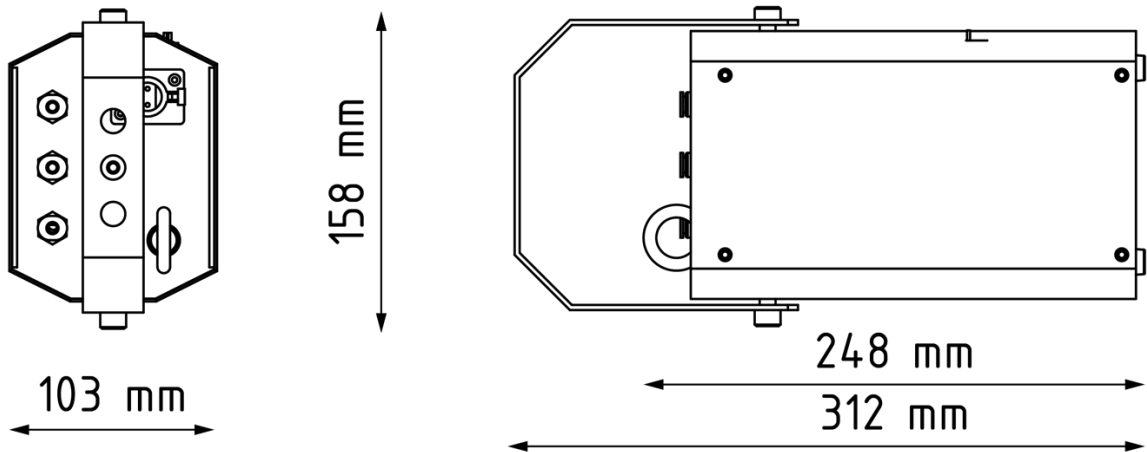

# LCU-2S



LIQUID SUPPLY UNIT

## 中文使用說明書

### 1. 前言

在操作本機器之前，請務必仔細詳閱本說明書然後請將本說明書放置在機器使用者可隨時查閱之處存放。此說明書包含如何安全的安裝及操作本機器以及說明所有在機器上的標示。如果您有任何操作上的問題，請立即聯繫當地的 Antari 經銷商尋求協助。

### 2. 安全注意事項

 <b>危險</b>	若不確實避免這些指示，可能導致嚴重人身傷害甚至死亡。
 <b>警告</b>	若不確實遵循這些指示，可能導致嚴重人身傷害甚至死亡。
 <b>注意</b>	若不確實注意這些指示，可能導致人身傷害甚至死亡，嚴重程度視情況而定。

#### 危險

- 請務必使用正確電壓。如果使用錯誤電壓，可能會遭受危險的電擊燒傷或更嚴重的後果。
- 請勿在捆綁電源線的情況下使用，可能會發熱導致火災。
- 操作機器時請勿將機器對著人體、動物或火焰使用。

#### 警告

- 請於堅固、平坦、穩定且通風良好的表面上使用機器。請勿遮蓋機器散熱部份，機器周邊至少應保留 50 公分的空間並確認附近沒有易燃性物質或可揮發性氣體。
- 請勿隨意拆卸、修理或改造機器，這可能會導致機器故障、損壞、觸電危險或造成火災。
- 本機器僅限有行為能力之成人或專業人員操作，不預期提供生理、感知、心智能力、經驗或知識不足者之使用者(包含孩童)使用本機器。
- 請勿在無人看管時讓機器運作，並於外出離去時確實關閉電源。
- 孩童應受監督，以確保孩童不能操作或嬉戲玩本機器。
- 請勿將機器倒放或傾斜使用，可能導致機器動作不正常或損壞。
- 請將液體存放在室內孩童無法取得之處，保持通風及避免陽光直射。如果有觸碰眼睛或誤食機器，請立即尋求醫生的協助。

#### 注意

- 本機器無防水設計，請隨時保持機器乾燥，嚴禁將其潑水、浸水、淋雨或放在潮溼的環境。
- 在插入電源插座前，請確認電源插座無損壞或鬆動。
- 若電源線損壞，必須使用原廠電源線或組件進行更換，否則將導致保固無效。
- 在運輸本機器前，請確認機器的油箱已清空並且包裝完整。(建議使用原廠包裝)
- 本產品僅限室內使用。
- 請勿在電壓不穩定的地區使用本機器。
- 如果機器出現異常聲音或有任何不正常現象時，請立即停止工作，將電源關閉及拔下機器電源線，並請聯繫當地的 Antari 經銷商尋求協助。
- 請勿觸碰機器內部運轉零件。
- 只能使用原廠建議或販售之配件。
- 請確認機器不在使用的狀態下電源已關。如果長時間不使用機器，請拔掉電源線。
- 關閉機器時，將控制開關轉到關閉的位置，然後再將插頭從插座拔除。
- 拔除電源線時，請抓住插頭不是電線。
- 在保養及清潔前，請把電源線從插座拔除。
- 在電線或插座有損毀、機器故障或有掉落或損壞的情形發生時，請勿操作機器。請將機器送回最近的維修站，做檢查、維修及電源或機械的調整。
- 為確保機器的使用壽命，請使用 Antari 原廠製造之煙霧水，勿使用其它非 Antari 原廠製造煙霧水或添加劑，否則可能會導致故障。

在使用本機之前，請詳細閱讀機器上的警語標示，說明如下：

#### 底座印刷

##### 前

NEVER ADD FLAMMABLE SUBSTANCE 請勿添加易燃物質  
USE ANTARI RECOMMENDED FLUID 建議使用原廠液體

##### 後

#### **CAUTION 警告**

TO REDUCE THE RISK OF FIRE, REPLACE ONLY WITH SAME SIZE AND TYPE OF FUES  
僅限更換同尺寸及型號的保險絲，減少發生火災的風險

### 3. 包裝內容與檢查

在收到機器後，請立即小心地打開包裝紙箱，檢查所有內容，確認您所購買的機型及配件。如果有任何部件因運輸過程出現損壞或缺少，請立即連絡經銷商，並以原包裝退回檢查。

#### 3.1 包裝內容

- 1 x LCU-2S 主機
- 1 x LCU-2S 液體分流器
- 1 x IEC 電源線
- 1 x 3-Pin 數據線
- 1 x 12 公尺 6mm x 4mm 油管
- 1 x 10 公尺 4mm x 2.5mm 油管
- 3 x 4mm to 4mm 轉接頭
- 3 x 6mm to 4mm 轉接頭
- 1 x 濾嘴
- 1 x 快速入門指南

### 3.2 選配說明

品項	描述
N/A	N/A

### 4. 機器訊息

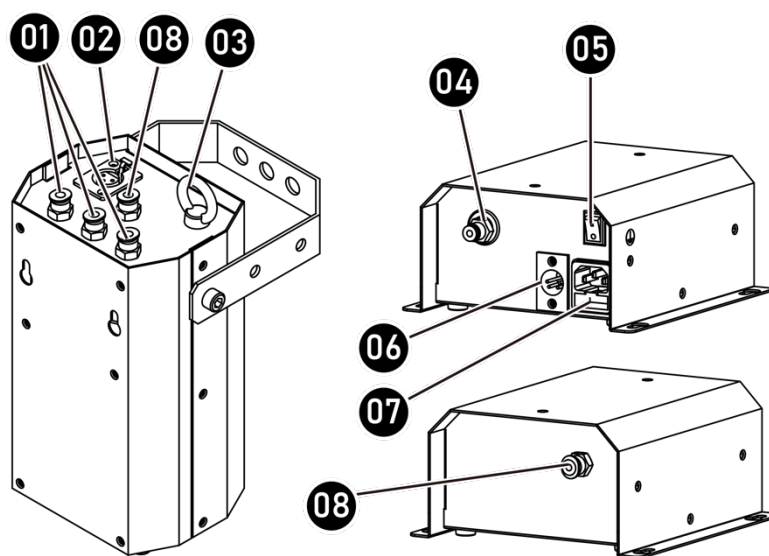

01. 油管接頭 4mm(輸出)	05. 電源開關
02. XLR 3-Pin In 連接頭(數據)	06. XLR 3-PinOut 連接頭(數據)
03. 安全吊環	07. IEC 連接頭(電源)
04. 油管接頭 6mm(輸出)	08. 油管接頭 6mm(輸入)

### 5. 技術標籤資訊

使用本機器前，請詳閱技術標籤上的訊息

<p>1. XXXX 2. INPUT VOLTAGE: 3. FREQUENCY: 4. RATED POWER: 5. BREAKER/FUSE:</p> <p>XXXX Vac 50/60Hz XXXW XXA 250V MADE IN TAIWAN XXXXXXMMYYXXXXXX</p> <p>6. QR CODE Scan It for User Manual</p> <p>7. SERIAL NUMBER</p>	
1. 機器型號	5. 斷路器/保險絲
2. 工作電壓	6. 說明書 QR CODE
3. 頻率	7. 機器流水序號
4. 瓦特數	

### 6. 設定與手動操作說明

	<b>警告</b> 機台掉落可能會造成嚴重傷害，請確保本機台安裝牢固且不會掉落。
--	---

#### 油管連接 (圖 1)

- 使用 6mm x 4mm 油管來連接“主機和液體分流器”及“主機和外接油桶”(務必將濾嘴裝在進入外接油桶的油管末端)

- 使用 4mm x 2.5mm 油管連接“液體分流器和機器油管連接頭”

**數據連接 (圖 2)**

- 3-Pin 數據線是用來連接“主機和液體分流器”

**注意:**

本裝置有內建過熱保護裝置，當裝置過熱時會自動停止運作，待恢復到正常工作溫度時，裝置會自行啟動。

**圖 1**

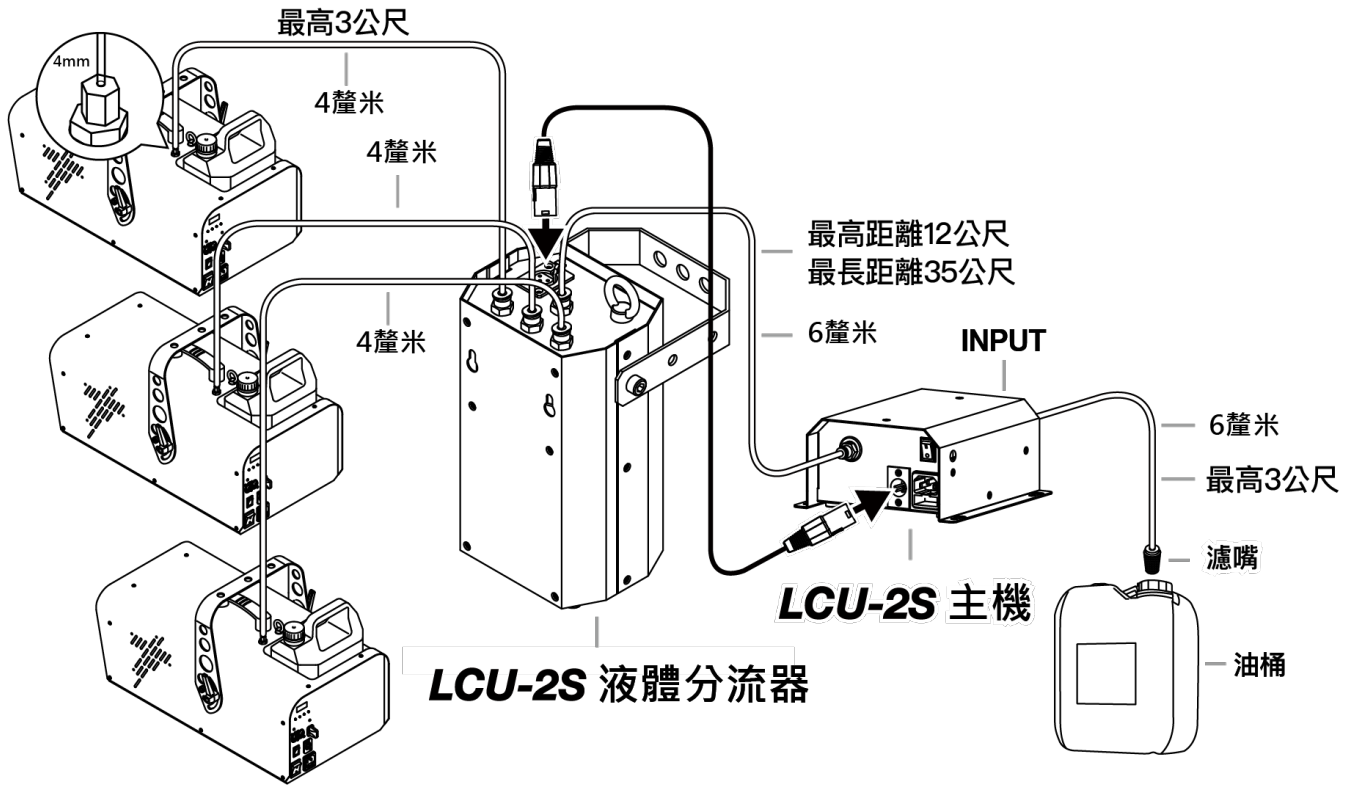

**圖 2**

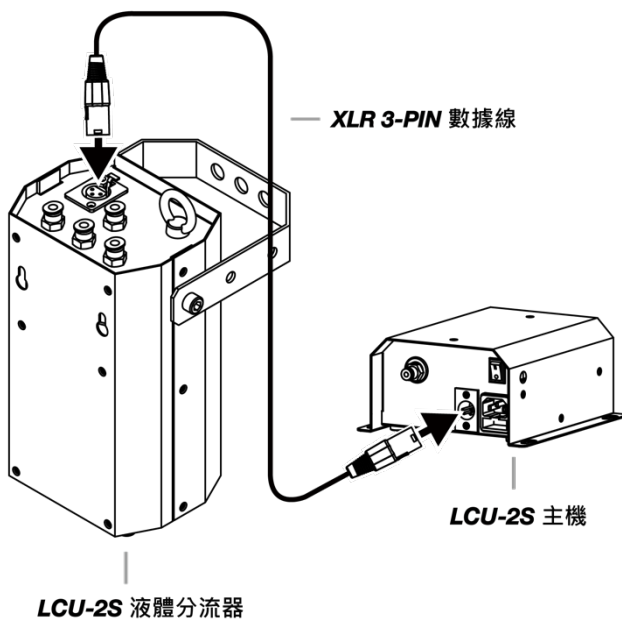

## 7. 維護和保養

	<b>危險</b>	維修保養之前，請務必拔除電源線
---	-----------	-----------------

- 隨時保持機器清潔及乾燥。
- 可以使用空氣壓縮機、吸塵器或軟刷除去機器上的灰塵。
- 機殼可使用濕布擦拭。
- 在存放機器前或使用機器後，請確認液體已經完全清空並保持乾燥。
- 建議每月至少讓機器運轉一次，以保持機器處於最佳的性能和輸出條件。
- 機器上過多的灰塵、液體殘餘累積的髒污會降低機器工作性能，導致散熱不良。

### 保險絲規格

120V = T0.8A 250V

230V = T0.8A 250V

## 8. 技術規格

	主機	液體分流器
輸入電壓	美規 : AC 100 - 120V, 50 / 60 Hz 0.5A 歐規 : AC 220 - 240V, 50 / 60 Hz 0.5A	
額定功率	55 瓦	
油桶容量	0.8 公升 (0.21 加侖)	
適用煙霧水	Antari 煙霧水/雪花水	
適用環溫	5°C - 40°C (41°F - 104°F)	
控制方式	自控	
介面	IEC (主電源) XLR 3-Pin (數據線)	
隨附配件	XLR 3-Pin 數據線 FT-6 12 公尺 6mm x 4mm 油管 FT-4 10 公尺 4mm x 2.5mm 油管 FTA-44 轉接頭 (4mm 轉 4mm) *3 FTA-64 轉接頭 (6mm 轉 4mm) *3 FLF-6 濾嘴	
選購配件	N/A	
尺寸	<b>油量供應器</b> 長 179 寬 168 高 84 公釐 長 7.05 寬 6.62 高 3.31 英寸 <b>液體分流器</b> L158 W103 H312 公釐 長 6.22 寬 4.06 高 12.29 英寸	
重量	<b>油量供應器</b> 2.0 公斤 4.40 磅 <b>液體分流器</b> 1.8 公斤 3.97 磅	

## 9. 保固聲明

本公司保證我們的商品在一年內沒有材料和製作缺陷。我們在本保證下的義務和責任僅限於在原廠或當地授權經銷商進行的維修或更換。我們對不當使用或用於非專門設計目的以外之用途不承擔任何責任。本保固不適用於以任何方式在原廠或當地授權經銷商外修理、改動或組裝的任何商品，以便我們判斷影響其性能，沒有受到誤用、疏忽或事故的影響，也沒有違反我們的任何商品操作印刷說明。本公司對於從我們這邊購買的商品不會允許也不對於使用、銷售或修理任何產品有關的任何類型的任何損失或損害承擔責任。

## 10. 機器尺寸圖 (換圖)

### 主機

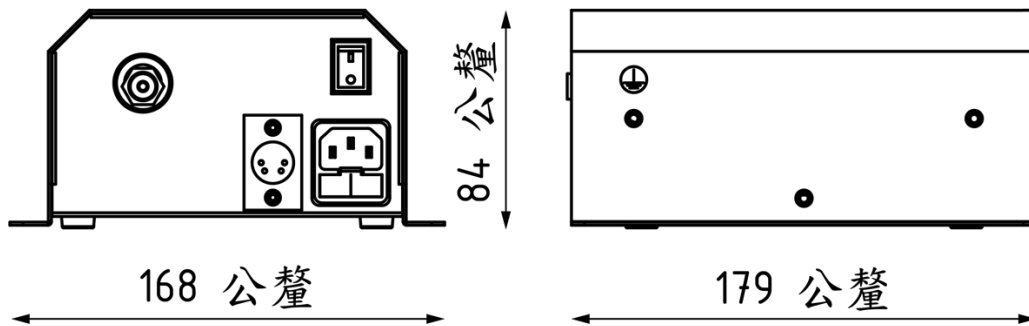

### 液體分流器

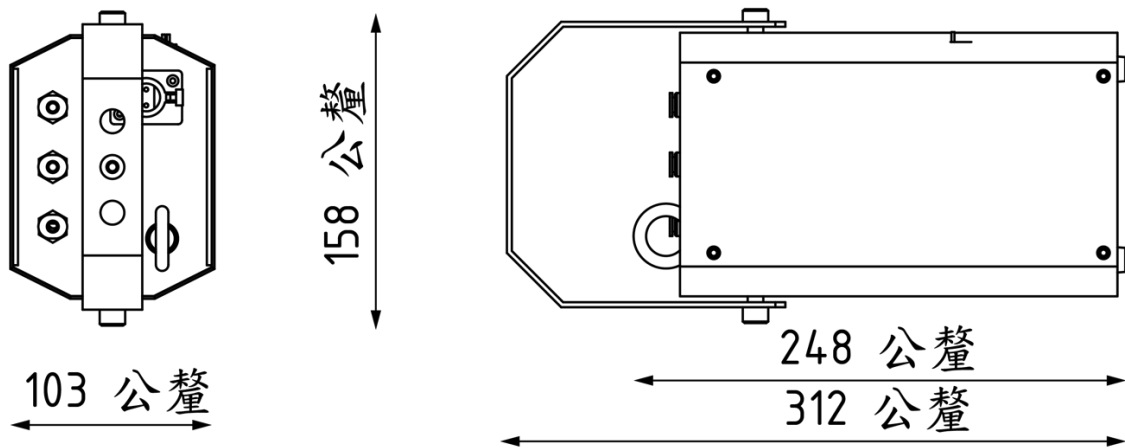





C08LCU2S3